

F/S Self-Propelled Sprayers

Sprayers/Liquid Handling

Self-Propelled Sprayers



Standard Features:

- New International TerraStar with 300 HP Turbo Diesel, 5-speed Automatic Transmission & 9.5 x 48 (16- ply radial tires mounted on the F/S Hytrux Chassis
- 710 Gallon Tank with center sump, bottom fill & Delta Rinse Ball (Also available with 750 or 850 Gallon Tank)
- Live PTO Hydraulic Pump operating Ace Centrifugal Wet Seal Pump and Hydraulic Fold and Tip Lift
- TeeJet 844E Auto Rate Controller, 3-Bank Manifold Ball Valves & Single Nozzle Bodies
- Boom Sizes: 60 - 90 Foot
- Track 124" Center to Center
- Lock-Up Rear Wheels - equivalent performance to 4 wheel drive
- All Mechanical Drive
- 54 inch Frame Clearance
- Spray Height Clearance of 30 - 60 inches
- Double Suspension - Truck Chassis suspension is fully functional / Lower Chassis frame is jointed
- Easily serviceable
- Up to 40 MPH road speed capability
- More Fuel Efficient than other self-propelled sprayers
- Patented "Cushion Boom" full hydraulic fold, boom & tip lift
- Knee-Action self-leveling booms
- Costs significantly less than other self-propelled units
- 1 Year Sprayer Warranty



Options:

- GPS System
- Foam Marker
- 5-Bank Manifold Ball Valves
- Electric End Nozzles
- Triple Nozzle Bodies
- RiteHeight Sprayer Boom Height Controller



CALL FOR PRICING

F/S Trailer Sprayers



1,000 Gal. Model

Standard Features:

- Patented Self-Leveling, Knee-Action, Rear-Mount Cushion “T” Boom with Hydraulic Fold, Height Adjustment & Tip Lift
- 1,000 or 1,500 Gallon Tank with center sump & bottom fill kit
- 55 Gallon Rinse Tank with Delta Rinse Ball
- 3 Gallon Safety Rinse Tank
- Hypro Hydraulically-Driven Centrifugal Pump
- TeeJet 844E Auto Rate Controller, 3-Bank Manifold Ball Valves & Single Nozzle Bodies
- Adjustable Wheel Spacing from 84 to 120 inches
- 9.5 x 48 - 16 ply radial tires (1,000 gal.) / 13 x 46 tires (1,500 gal.)
- “Sta-Lok” Hydraulics
- Access Platform
- Adjustable Hitch

Options:

- GPS System
- Foam Marker
- 5-Bank Manifold Ball Valves
- Electric End Nozzles
- Triple Nozzle Bodies
- RiteHeight Sprayer Boom Height Controller

• Durable yet much lighter than other pull-type units due to the boom design
• Pulls Easy and Saves Fuel
• Spray Height 28 to 60 inches
• Boom sizes 60 - 90 foot



1,500 Gal. Model



1,500 Gal. Model



1,500 Gal. Model

CALL FOR PRICING

“YOU MIGHT AS WELL HAVE THE BEST”

1-800-333-2314

F/S Truck Mount Sprayers

Sprayers/Liquid Handling

Truck Mount Sprayers



Standard Features:

- Patented Self-Leveling, Knee-Action, Mid-Mount Cushion “T” Boom
- 400 Gallon Tank with center sump & bottom fill kit
- 8 HP Honda Engine with Cyclone Air Cleaner
- Hypro Belt-Drive Centrifugal Pump
- In Cab 3-Boom Controller with Pressure Regulator
- 3 Gallon clean water safety rinse tank
- Single Nozzle Bodies

CALL FOR PRICING

Options:

- GPS System
- Foam Marker
- 3 or 5 Bank Manifold Ball Valves
- Electric End Nozzles
- Triple Nozzle Bodies
- Boom Sizes 60 - 90 Ft.
- TeeJet Auto Rate Controller
- Hydraulic Fold, Boom & Tip Lift
- Live PTO Hydraulic Pump operating Ace Centrifugal Pump and Boom Lift/Fold Functions
- 500, 750 or 1,000 Gal. Tank
- Electric Start for Honda Engine
- RiteHeight Sprayer Boom Height Controller

Note: The Hydraulic Tip Lift Kit can also be sold separately and retrofitted to function on some sprayers by other manufacturers. Call today to discuss your options!

Touchdown Wheels

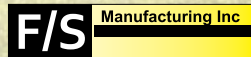

Features:

- 14” Solid Tire / Ball Bearing Wheel
- Complete with U-Bolts
- Fits Up To a 2” Square Tube
- All Steel Bracket



PART#	Description	Price	G
TD	Pair of Touchdown Wheels	\$125.00	
TDSINGLE	Single Replacement Wheel	\$35.00	

Foam Marker **F/S** Manufacturing Inc



Features:

- 12V DC Operated
- Electric Controls Enclosed in Weatherproof Cover
- 3-Position Switch with Wiring Harness
- Two Stage Foam Generation
- Boom end Mounted Foam Chambers
- 100 Foot Delivery Hose (FM14/25 Only)
- 4" Drop Boots
- Fluorescent Lime Drop Boots for Visibility

PART#	DESCRIPTION	Price	G
FM6	6 Gallon Foam Marker	\$619.00	
FM14	14 Gallon Foam Marker	\$671.00	
FM25	25 Gallon Foam Marker	\$692.00	

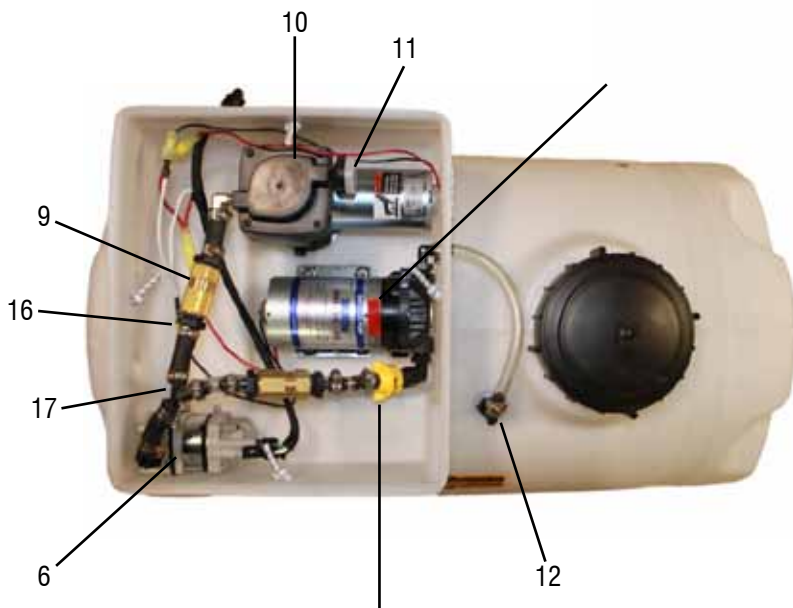

Foam Marker Parts List

Sprayers/Liquid Handling

Foam Markers - Parts List

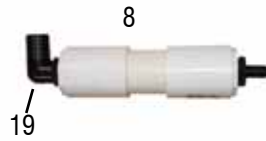

No	PART#	DESCRIPTION	Price	
1	10049	25 Gallon Tank	\$73.80	G
1	10050	14 Gallon Tank	\$52.70	G
2	10051	Weather Housing	\$42.10	C
3	10052	Housing Top	\$24.90	
4	10053	Bungee Strap	\$1.60	C
5	10054	Tank Lid	\$9.10	C
	10055	Solenoid Valve (Spraying Systems)	\$135.60	M
6	10055A	TR 2504 Solenoid	\$135.60	M
7	10056	Orifice Assembly	\$9.10	C
8	10057	Foam Chamber Assembly	\$18.00	C Each
9	10059A	Check Valve Assembly	\$28.30	I
10	10060B	Air Compressor – Gast 22D1	\$190.60	G
	10060C	Brass Elbow, Output Side Compressor	\$3.50	I
	10061	Diaphragm Kit – Thomas	\$26.50	C
	10061A	K707 Service Kit – Gast 22D1	\$21.10	C
	10061B	DPH 1001 Diaphragm – Gast 22D1	\$10.70	C
	10062	Air Cleaner – Thomas	\$6.40	C
	10062A	Air Cleaner Filter – Gast 22D1 – AA929	\$1.00	I
11	10062B	Air Cleaner – Gast 22D1 – Complete	\$4.10	I
12	10063	Siphon Tube Assembly	\$10.30	C
	10064	Harness Assembly	\$82.80	C
	10064A	Harness Pigtail	\$29.50	C
	10064Ext5	5' Harness Extension	\$30.10	I
	10064Ext10	10' Harness Extension	\$36.10	I
	10064Ext20	20' Harness Extension	\$49.20	I
13	10067	Shurflo Pump	\$97.20	C
14	10068	Tip Mount Plate	\$4.30	C Each
15	10069	Clamp BC-32	\$1.10	C Each
16	10070	Clamp SSC-4	\$0.70	C Each
	10071	Screw 12 x 14 x 1	\$0.20	C Each
	10072	FM Switch 4 x 851	\$9.60	C
	10073	Full Change Over Kit – (Items Include 2, 4, 19, 20, & 22)	\$83.70	C
	10075	End Chamber Kit (1) 8, (2) 19, (4) 20, (4) 22	\$30.10	C
	10076	F/S Manufacturing Decal	\$0.00	C
	10077	Y Hose Assembly (1 Check Valve)	\$32.60	C
17	10078	Y Hose Assembly (2 Check Valves)	\$59.80	C
18	10079	HD Drop Boot Assembly	\$18.00	C
19	10080	HBE 34100	\$0.90	F
20	10081	Clamp BC12	\$1.00	
21	10082	Clamp BC6516	\$0.90	
22	10083	Drain Plug	\$4.10	
	TY66PP	3/8 "Y" Poly Connector	\$1.00	C



Features:

- Extra Heavy Duty Construction
- 12V Motor with Hand Control
- Manual Crank Handle Included
- Guide Tubes for Easy Retrieval
- All Steel Double O-Ring **Liquid Lock** Swivel
- Manual Clutch Lockout for Easy Pull-Out



Double O-Ring **Liquid Lock** Swivel

Options:

- Wireless Remote Control
- Stainless Steel Swivel (2" or 3" only)

F/S Super Reel

PART#	DESCRIPTION	Price	I
HR100	1" Manual Hose Reel	\$479.00	
HR200	2" Manual Hose Reel	\$795.00	
HRE100	1" Electric Hose Reel	\$679.00	
HRE200	2" Electric Hose Reel	\$995.00	
HR2SSU	2" SS Swivel Upgrade	\$133.00	
HRE300	3" Electric Hose Reel	\$1,449.00	
HR3SSU	3" SS Swivel Upgrade	\$155.00	
	Replacement Parts		
HR10	Electric Motor for Hose Reel	\$199.00	
HR11	Remote Control for Hose Reel	\$47.00	
HRH	Crank Handle	\$8.50	
HRSW-2	2" Swivel	\$195.00	
HRSW-3	3" Swivel	\$310.00	
HRSS-2	2" Stainless Steel Swivel	\$335.00	
HRSS-3	3" Stainless Steel Swivel	\$465.00	
HR02	2" O-Ring	\$0.90	
HR03	3" O-Ring	\$0.95	
HRWRU	Wireless Remote Upgrade (fits all Electric Models)	\$195.00	

Specifications:

	Dimensions	Weight	Hose Capacity
HR/HRE100	22"L x 29"W* x 22"H	132 lbs	500' (1/2" Yellow Ag Hose) or 100' of 1" Bumblebee
HR/HRE200	29"L x 31"W* x 27"H	150 lbs	75' of 2" Bumblebee
HRE300	41"L x 31"W* x 39"H	255 lbs	75' of 3" Bumblebee

*Manual Crank Handle adds 5" to width



HRE 300

HRE 200

HRE 100

TRU-KLEEN Chemical Inductors empty to the last drop...

PART#	DESCRIPTION	Price	G
TK20	20 Gal. Tru-Kleen Tank - 18" Dia.	\$74.00	
TKS20	Stand for TK20	\$75.10	
TK20KIT	20 Gal. Inductor Kit - 18 x 39	\$191.10	
TK30	30 Gal. Tru-Kleen Tank - 18" Dia.	\$90.90	
TKS30	Stand for TK30	\$75.10	
TK30KIT	30 Gallon Inductor Kit - 18 x 48	\$208.00	
	Magnum Inductors		
TK40M	40 Gal. Tru-Kleen Magnum Tank - 28" Dia.	\$121.30	
TKS40M	Stand for TK40M	\$121.30	
TK40MKIT	40 Gal. Magnum Inductor Kit - 28 x 40	\$284.60	
TK65M	65 Gal. Tru-Kleen Magnum Tank - 28" Dia.	\$144.90	
TKS65M	Stand for TK65M	\$121.30	
TK65MKIT	65 Gal. Magnum Inductor Kit - 28 x 48	\$308.20	
TK100M	100 Gal. Tru-Kleen Magnum Tank - 35" Dia.	\$202.20	
TKS100M	Stand for TK100M	\$180.60	
TK100MKIT	100 Gal. Magnum Inductor Kit - 35 x 48	\$424.80	
TK200M	200 Gal. Tru-Kleen Magnum Tank - 35" Dia.	\$298.80	
TKS200M	Stand for TK200M	\$180.60	
TK200MKIT	200 Gal. Magnum Inductor Kit - 35 x 78	\$521.40	



- Features:**
- 2" Male Threaded Snout (No Bulk-Head Fittings)
 - Stand is Drilled and Ready to be Bolted Down
 - 16" Vented Lid



Sprayers/Liquid Handling

Tru-Kleen Inductor Products

Options:

- Inductor Kit - Includes Tank, Stand, 2" Ball Valve, 2" Tee & Hose Barbs (Kit also available for 3" Plumbing - see below)
- Cone Rinse System - Washes Chemical out of Entire Tank
- Jug Rinse - Rinse Ball Leaves no Wasted Chemical in Your Jugs
- Vortex Plates - Prevent your Pump from losing its prime
- Jet Rinse - Multi-Directional Spray Rinses Chemical Containers



Cone & Jug Rinse Systems Fit ALL TK Inductor Tanks!

PART#	DESCRIPTION	Price	
TKKIT3	3" Plumbing Upgrade for All Sizes of Inductors (requires tall stand)	\$53.00	G
TKC	Tru-Kleen Cone Rinse System	\$46.20	G
TKJUG	Tru-Kleen Stainless Jug Rinse	\$131.30	I
TKV20	Vortex Plate for 20 or 30 Gal. Inductor	\$21.00	I
TKV40	Vortex Plate for 40 or 65 Gal. Inductor	\$31.50	I
TKV100	Vortex Plate for 100 or 200 Gal. Inductor	\$52.50	I
JET RINSE	Jet Rinse Container Rinsers	\$37.70	

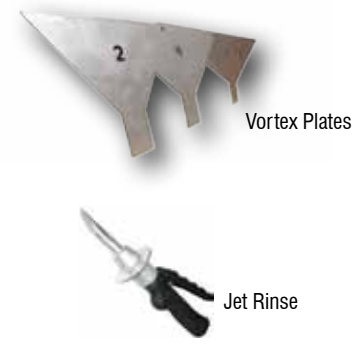

TRU-KLEEN Air Keg Measuring Cylinder empty to the last drop...

- Features:**
- 25 Gallon Tank - 12" Diameter with 1/2" Sight Gauge for Accuracy
 - 6" Vented Cap
 - TeeJet Internal Rinse Ball for Thorough Rinsing

PART#	DESCRIPTION	Price	G
TK25	25 Gal. Air Keg Tank & Stand	\$300.00	
TK25KIT	25 Gal. Measuring Kit	\$405.00	

TRU-KLEEN

Chemical Injector empty to the last drop...

Features:

- Injects Chemical into Pump Pressure Line (Installed after Pump)
- Keeps Pump Free of Chemical
- Rinses Cones
- Mixes Dry Chemical

PART#	DESCRIPTION	Price	G
TKINJ20	20 Gal. Tru-Kleen Chemical Injector	\$657.00	
TKINJ30	30 Gal. Tru-Kleen Chemical Injector	\$678.00	
TKINJ40	40 Gal. Tru-Kleen Chemical Injector	\$742.00	
TKINJ65	65 Gal. Tru-Kleen Chemical Injector	\$758.00	
TKINJ3U	3" Venturi Upgrade	\$269.00	
TKJUG	Tru-Kleen Stainless Jug Rinse	\$131.30	I
MIS220AA	2" Manifold Venturi Bypass Only	\$467.00	
MIS300	3" Manifold Venturi Bypass Only	\$736.00	



2" Manifold Venturi



TRU-KLEEN

Batch Master

empty to the last drop...

Features:

- 100 Gallon, 3 Point Recirculating Tru-Kleen Tank with 5.5 HP Honda Engine and 2" Banjo Pump
- Powers an Entire Loading System
- Mixes Dry Chemical

PART#	DESCRIPTION	Price	I
BATCHMASTER65	65 Gal. Batch Master with Motor	\$1,169.00	
BATCHMASTER65-NM	65 Gal. Batch Master without Motor	\$593.00	
BATCHMASTER100	100 Gal. Batch Master with Motor	\$1,266.00	
BATCHMASTER100-NM	100 Gal. Batch Master without Motor	\$689.00	

TRU-KLEEN

Mix Master

empty to the last drop...

Features:

- Custom Assembled & Plumbed with Equipment of Your Choice
- Fully Functional System Mounted as One Piece, Ready to Slide into Your Van or Trailer and Use Immediately!

CALL US FOR CUSTOM ASSEMBLY!

PART#	DESCRIPTION	Price	I
MIXMASTER	Frame Assembly	\$368.00	



Sample Assembly



TRU-KLEEN Chemical Processor
empty to the last drop...

Features:

- Loads Chemical from Totes or Barrels without a pump (your Transfer Pump powers the Banjo Venturi to create suction)
- Mechanical Measuring - No Meters
- Induction of Chemical from Jugs
- Rinses both Cones
- Rinses Jugs

PART#	DESCRIPTION	Price	G
TKPRO	2" Chemical Processor	\$1,850.00	
TKPRO3	3" Chemical Processor	\$1,990.00	

COMPLETE CHEMICAL HANDLING IN ONE MACHINE!

Sprayers/Liquid Handling

Tru-Kleen Chemical Handling

TRU-KLEEN Chemical Inoculator **empty to the last drop...**

Features:

- 20 Gallon Tank
- Adjustable Magnetic Nozzle Mount
- 0-60 Pound Liquid Pressure Gauge
- Variable Rate
- 115V Pump with 20 ft. Power Cord
- Pneumatic Tires

PART#	DESCRIPTION	Price	G
TKI	Tru-Kleen Inoculator	\$520.00	



TRU-KLEEN Auger Treater **empty to the last drop...**



Features:

- 3 or 5 Gallon Models
- Mounts on a Truck Box or Auger
- Two Outlets for Thorough Coverage

PART#	DESCRIPTION	Price	G
TBT3	3 Gal. Truck Box Auger Treater	\$335.00	
TBT5	5 Gal. Truck Box Auger Treater	\$367.00	
TBT115	115V Optional Auger Treater	\$62.00	

Planter Fertilizer Kit

Features:

- Push-Pull Fittings
- Mounting Bracket for 7" Square Tube
- 3/8" U Bolts
- 1/4" Nylon Tubing
- Cab Isolator (see pg. 15)
- Rubber Feed Hose
- Manifold
- Filter
- Orifices



PART#	DESCRIPTION	Price	I
PK8	8 Row Planter Kit	\$345.00	
PK12	12 Row Planter Kit	\$375.00	
PK16	16 Row Planter Kit	\$575.00	
PK24	24 Row Planter Kit	\$650.00	
PKW	Wilger Flow Monitor Upgrade (per row)	\$16.00	
	Add 1 Pump Below to Complete Your Kit		
4101XL-EH-ESC	7.5 GPM Stainless Steel Roller Pump with 12V DC Motor and Speed Control (MSC30-DD)	\$967.50	
FMC-75-HYD	20 GPM Hydraulic Centrifugal Pump - for 16 or 24 Row Kits	\$625.00	
5850-111E-ESC	5 GPM Delavan 12V Pump and Electric Speed Control	\$468.50	
7970-111Y-ESC	7 GPM Delavan 100 PSI and Electric Speed Control	\$614.50	

Planter Fertilizer Kit Options & Parts



Planter Tank Stand



Tool Bar Tank Stand

Options:

- 55, 110, 150 or 200 Gal. Horizontal Tanks
- 300, 400 or 500 Gal. Elliptical Tanks
- Wilger Flow Monitors
- Digital Speed Control
- Tool Bar Tank Stand
- Planter Tank Stand



30 Amp Digital Speed Control (MSC30-DD)



35 Amp Speed Control (ESC35-SS)



Orange Plastic Spoon (ROPS) with YNOT Split-It Kit

Orange Plastic Spoon Features:

- guides seeds to the bottom of the furrow
- enters the seed trench right behind the discs
- shaped like the seed V
- peels seeds off the sidewall & funnels them to the bottom
- does not press the seed in the ground
- easy to install
- can be used with optional fittings & liquid fertilizer attachments

PART #	DESCRIPTION	Price	I
ROPS	Orange Plastic Spoons (per row)	\$34.00	
YNOT	Split-It Kit for ROPS	\$5.50	
PKSTAND	Tool Bar Tank Stand (pair)	\$265.00	
PTS	Planter Tank Stand (each)	\$210.00	
MSC30-DD	30 Amp Digital Speed Control	\$270.00	
ESC35-SS	35 Amp Speed Control	\$285.00	

Chemical Isolator

Features:

- Keeps Chemicals from Entering the Tractor or Truck for Added Operator Safety
- Dampens and Protects Pressure Gauges from Corrosive Chemicals
- Maximum Operating Pressure 150 PSI
- Pre-filled with Non-Toxic RV Anti-freeze
- Comes with Mounting Bracket and 1/4" Female NPT Threads on Both Ends



PART#	Price	G
2391	\$46.70	